

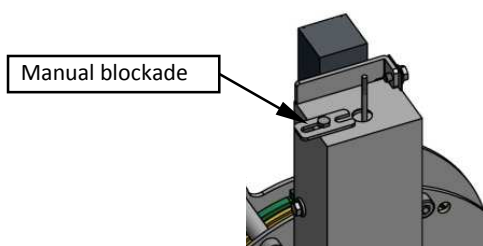

## CHECK AND CONNECTING THE AD20H SYSTEM

### Step 1 Remove the manual blockade

Before starting the AD20 system, check that the blockade has been removed.



### Step 2 Open the safety switch cover

Remove the screw, by means of the screwdriver, in order to open the safety switch cover

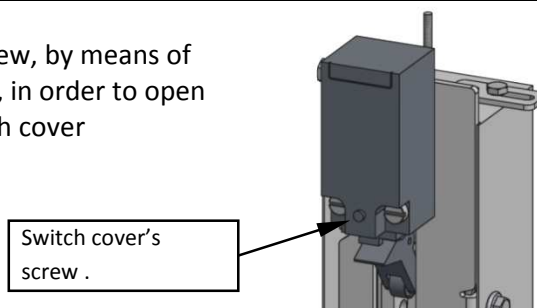

### Step 3 Remove the system cover

Remove the fixing screws(3.a) and remove the cover with a slight turning (3.b).

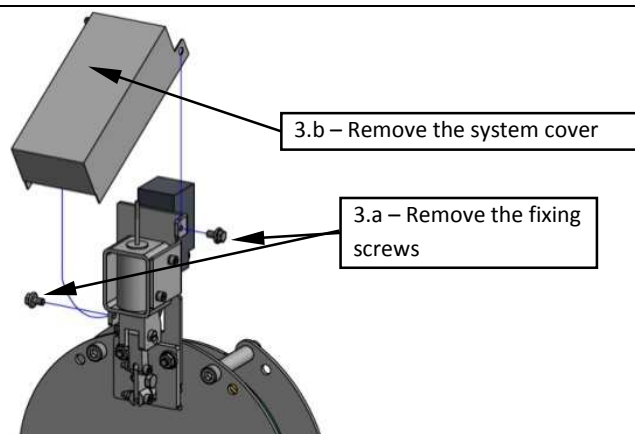

### Step 4 Check the working

In order to check that the system works properly:

- 4.1- Pull out the coil pin with the hand (or feed the coil with the right tension) and check the contacts (for example with an electrical tester). Contacts should be commuted, "NO" is closed and "NC" is open.
- 4.2- Remove the coil pin (get it free or without tension) and check that the contacts are not commuted (NO contact is open and NC is closed). When the coil pin is dropped, the system pin could fall in two different ways (see Table 1, step 4), over or under the teeth. It's very important to check that in both positions the contact remains in the same state ("NO" open and "NC" closed). At least should be checked "over the teeth" position, as this is the most unfavorable condition. You can check the teeth position (see table 1).

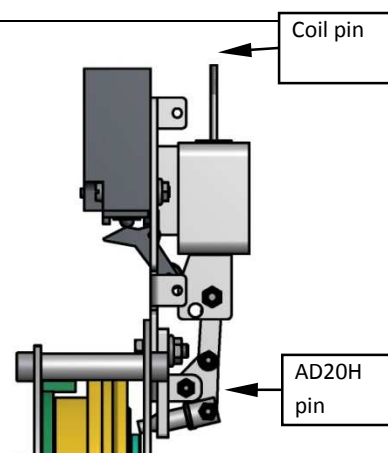



## ASSEMBLY MANUAL

Pulling ou the coil pin (or coil feeded)	Coil pin released (or not feeded coil)	
	System pin over the teeth	System pin under the teeth
		

Table 1

If steps 4.1 and 4.2 are not ok, you should adjust the safety switch, in order to place it in the right position, step 5.

If steps 4.1 and 4.2 are ok, go to step 6 (ignore step 5).

## Step 5 Safety switch adjustment (only if necessary)

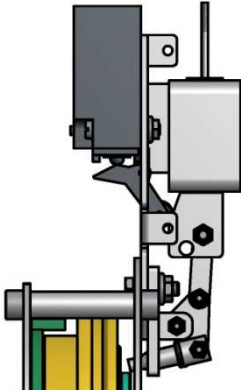
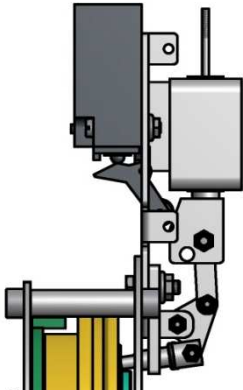
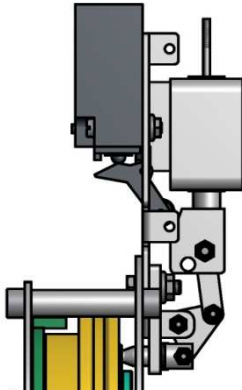
You should only adjust the switch position if checkings in step 4 have not been successful.

So you have to move the safety switch in order to place it in the right position, as following:

5.1-Loose the safety switch screws.

5.2-Move the switch up or down in the this way:

- When the system pin is over the teeth, the safety switch is not activated ("NO" open and "NC" closed).
- Pulling the coil pin, the switch is activated ("NO" closed and "NC" open).

5.3-Tighten the screws. By means of a flat spanner you could fix the nut.

5.4-Check again according to Step 4. If testings are not successful, proceed again according to Setp 5.

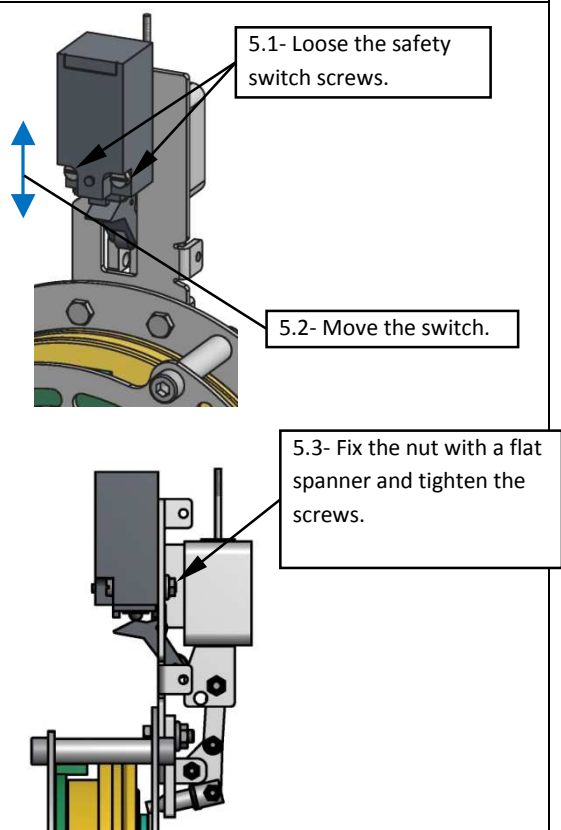



## ASSEMBLY MANUAL

**Step 6 Connecting AD20H**

After checking that the switch works properly, connect the safety switch to the lift dashboard.

The safety switch has got two possible contacts to connect, 1 "NO" + 1 "NC". Connect bearing in mind that:

Lift	Coil	Contact "NC"	Contact "NO"
Stopped (on floor)	Not feeded	Closed	Open
Moving	Feeded	Open	Closed

After connecting the contact, close again the switch cover (tighten the screw, step 2).

Then connect the coil to the dashboard (check the tension).

**Step 7 Final checkings**

Check the system working also with the dashboard functions.

